

EXISTING SITE PLAN 1:500

- notes:
1. This drawing is Copyright reserved and should be used only for the purposes intended in its original issue.
  2. This drawing is to be read in conjunction with all relevant drawings and specifications including those from other Consultants.
  3. Any existing dimensions should be checked on site and any discrepancies reported to the Architect.
  4. Do not scale off this drawing, use only figured dimensions. The Contractor is to bring to the attention of the Architect any discrepancies contained in this drawing prior to work commencing.

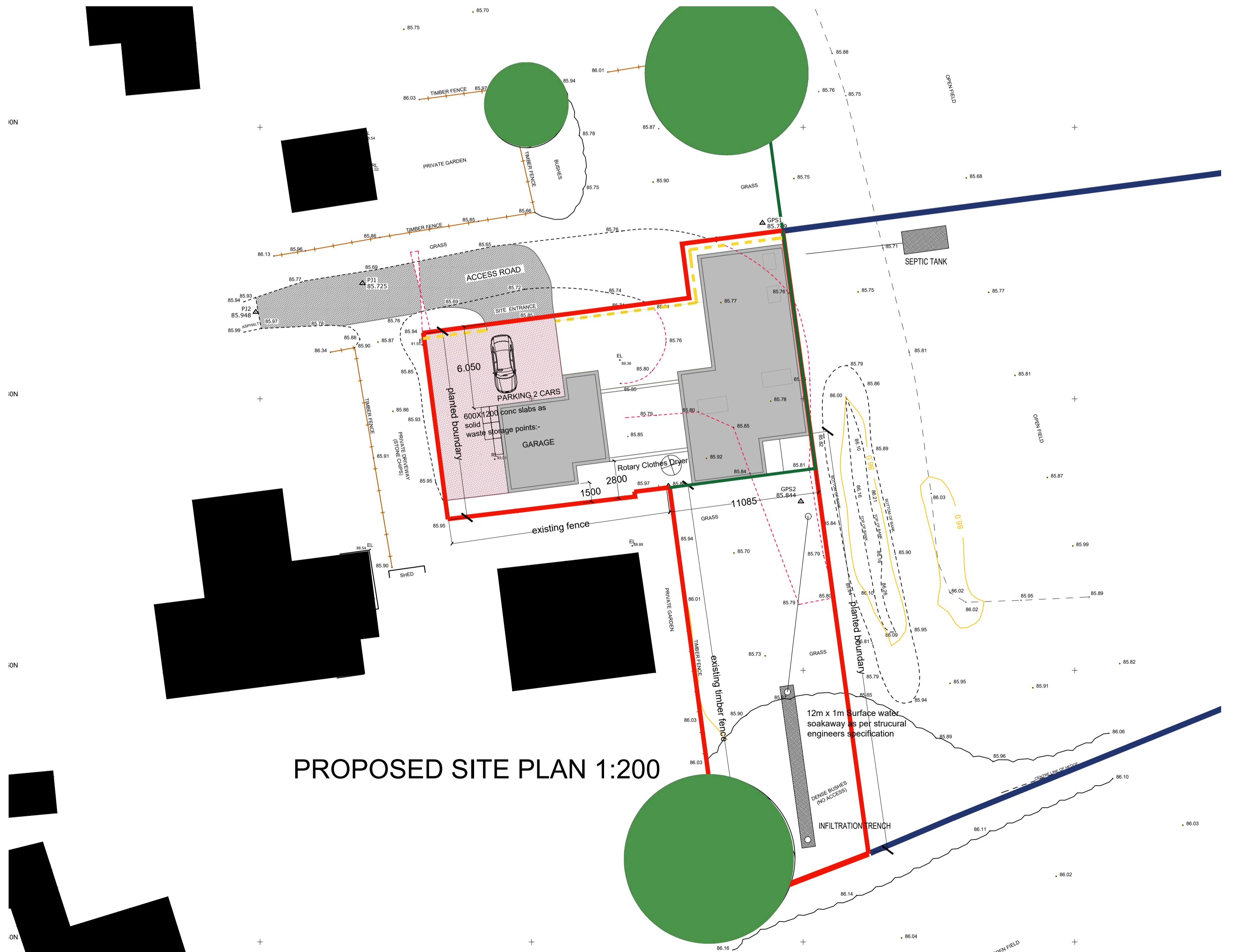

PROPOSED SITE PLAN 1:200

- EXISTING PROPERTIES
- PROPOSED HOUSE - 2 LEVELS
- PROPOSED HOUSE - 1 LEVEL
- LAND OWNERSHIP
- SITE BOUNDARY
- APPROVED DEVELOPMENT BOUNDARY / ZONE
- 1000MM HIGH PROPOSED GARDEN BOUNDARY WALL
- ACCESS ROAD
- PARKING AREA
- PROPOSED LANDSCAPING

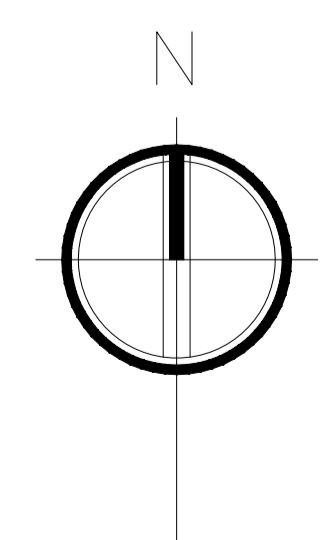
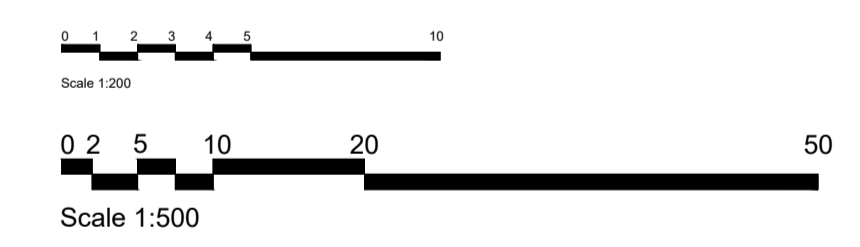

Revision	Description	By	Chk
project			

Mr & Mrs Purdie  
 Site North and East of Tweed Lodge  
 Hoebridge East Road  
 Gattonside

title  
 Site Plan  
 Existing & Proposed

scale	size	date	drawn	checked
1:200 / 1:500	A1	July 21		

drawing status  
 PLANNING

AITKEN TURNBULL ARCHITECTS  
 9 Bridge Place  
 Galashiels  
 TD1 1SN  
 01896 752760  
 enquiries@aitken-turnbull.co.uk  
 www.aitken-turnbull.co.uk  
 Also at Edinburgh & Dumfries



project no.	drawing no.	revision
AT3523	L(-)101.220222	