

18/01469/PPP

06.02.19

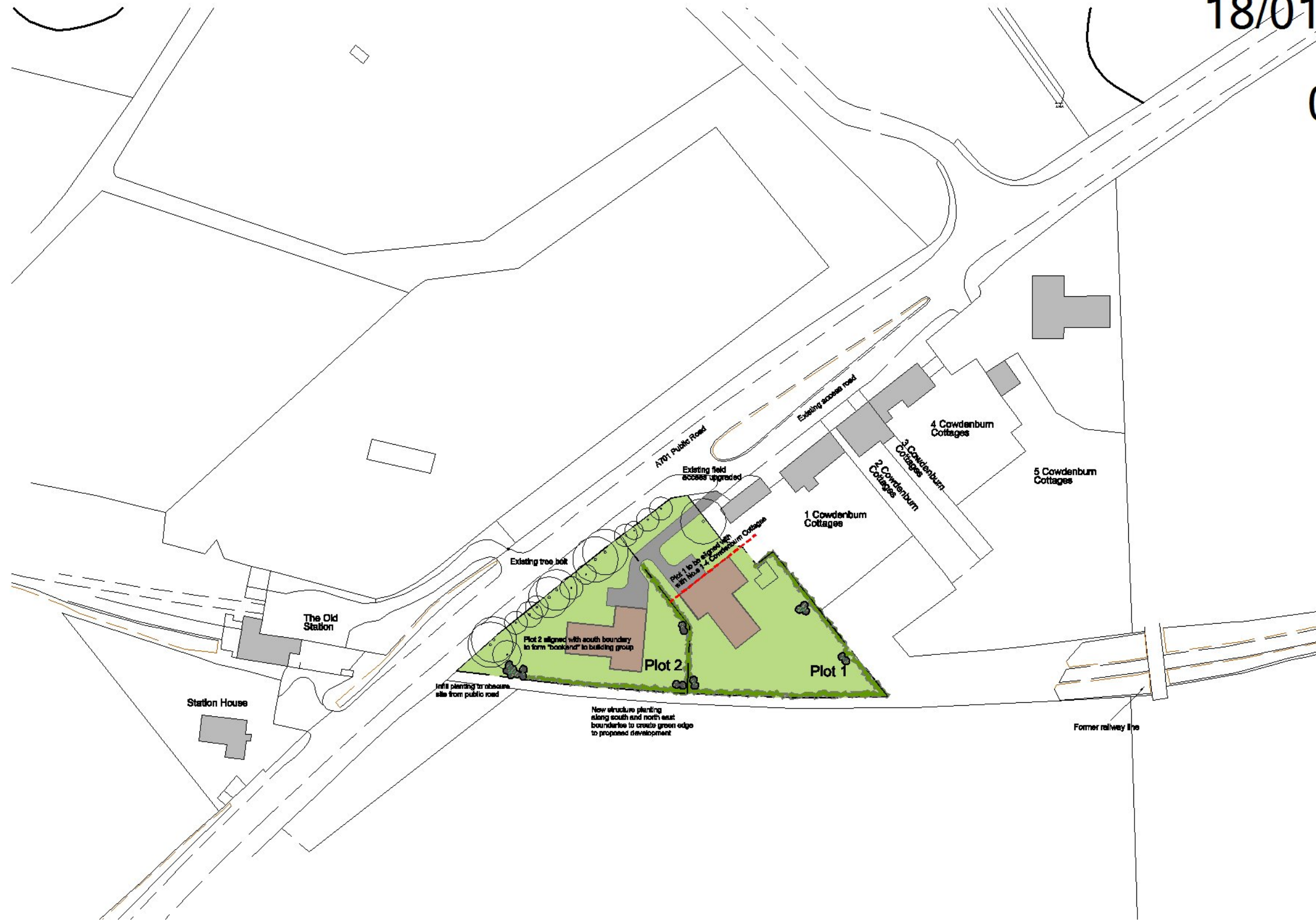

Scottish Borders Council  
Town And Country  
Planning (Scotland) Act  
1997

**REFUSED**

subject to the  
requirements of the  
associated Decision  
Notice

**Indicative Site Layout**  
Scale 1:500

**rm** architecture ltd  
Bloomfield, Heatherlie Park, Selkirk. TD7 5AL  
tel: 01750 21709  
email: rmarchitecture4@gmail.com

Client:  
**Mr & Mrs Anderson**  
Project:  
**Proposed Housing Development  
Land adj. to 1 Cowdenburn Cottages  
Lamancha**  
Title:  
**Indicative Site Layout**