

This is the plan referred to in the foregoing Disposition by  
Gandlberry Limited in favour of Raymond Keddie and Mrs June Keddie  
dated 31st February 2001

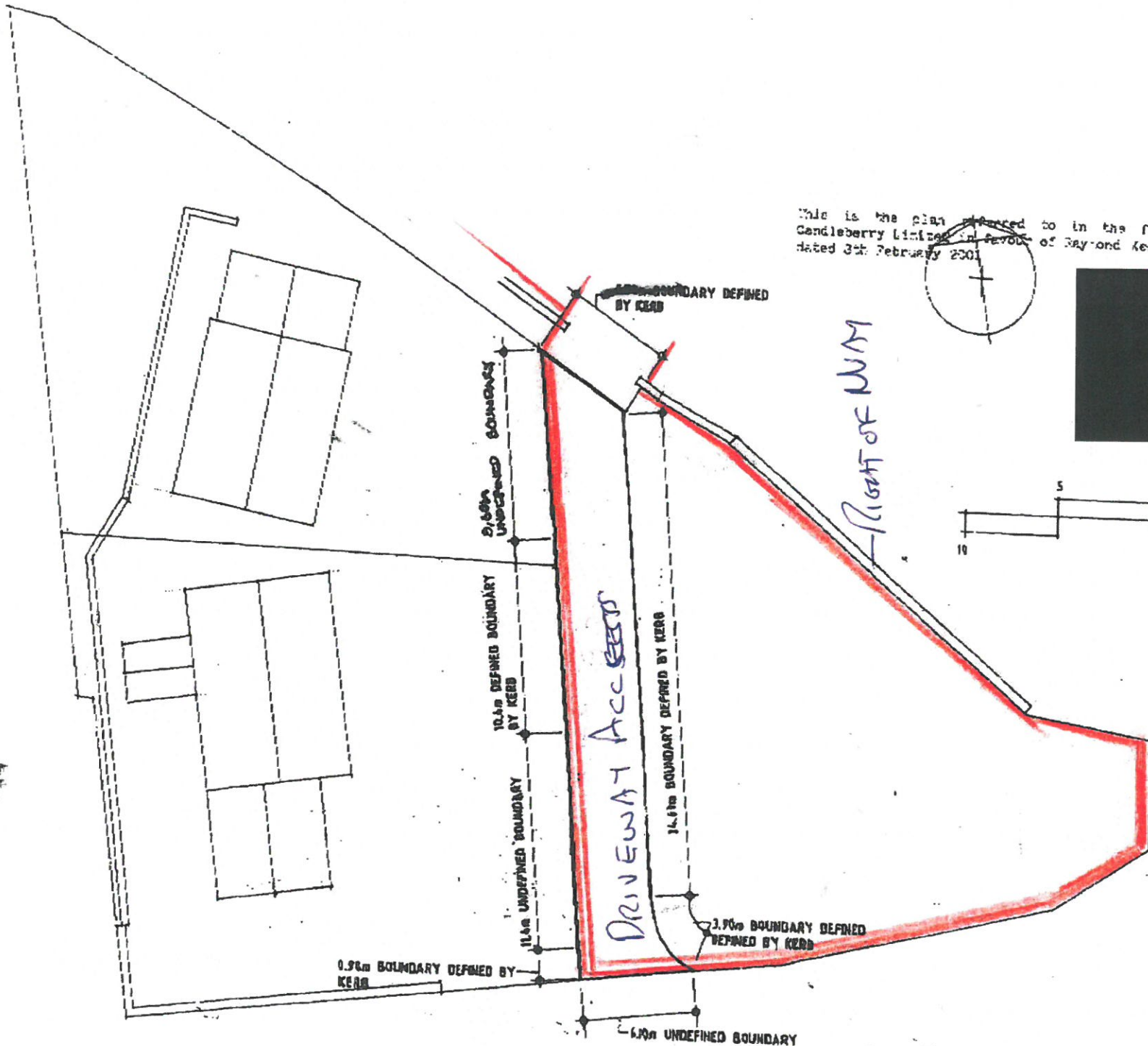
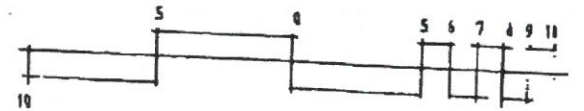
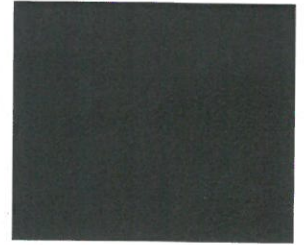
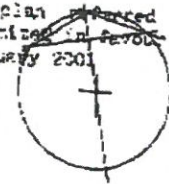

Fee Plan  
for  
Road to east of  
Rose Cottage, Maxwell  
Street, INNERLEITHEN  
to  
Mr Keddie

scale 1:200 november 2000